

SPECIFICATIONS & FEATURES

Model PSE-2001

## Single Compartment Self Contained Sink

This streamlined, self-contained, portable sink provides the perfect hand or utensil washing solution for both indoors and outdoors. It's compact and extremely lightweight, so you can move it to where it is needed, when it is needed. Hosting a family event in the park? This travels easily to make food serving easy and safe for all. Affordable, yet attractive, it's also perfect for offices, backyard patios, mall kiosks and more. Stores easily when not in use.



### Features .....

- Compact and lightweight and suitable for indoor and outdoor usage
- Contains one 6-gallon tank for fresh water and one 6-gallon tank for waste water
- Water Heater:
  - One-gallon Adjustable water heater that allows water temperature to be adjusted up to 145 degrees.
- Electric Water Pump
- 3" Swivel Casters (All Locking)
- ADA Compliant Faucet Handles
- GFCI Outlet Protection
- Construction: Industrial plastic cabinet
- Available with 10" deep sink
- Available Colors: Black color only
- One year limited manufacturers warranty

This item has met the following  
Certifications & Approvals

NSF Stainless Steel Sink is NSF  
Certified

UL, NSF, CSA Water Pump



*Note: Dimensions and specs subject to change without notice.*

**DIMENSIONS & SPECIFICATIONS**

## Single Compartment Self Contained Sink

<b>MODEL NUMBER</b>	<b>PSE-2001</b>
<b>MODEL NAME</b>	<b>Single Compartment Self Contained Sink</b>
<b>NUMBER OF BASIN</b>	<b>Single</b>
<b>BASIN MATERIAL</b>	<b>Stainless Steel</b>
<b>BASINS DIMENSIONS</b>	<b>10" W x 11"L x 5.5"D</b>
<b>TOP MATERIAL</b>	<b>Industrial plastic</b>
<b>CABINET DIMENSIONS</b>	<b>25.75" W x 17.75"L x 38.5"H</b>
<b>CABINET MATERIAL</b>	<b>Industrial plastic</b>
<b>PRODUCT WEIGHT</b>	<b>95 lbs</b>
<b>NSF CERTIFIED</b>	<b>YES</b>
<b>GPM</b>	<b>0.5</b>
<b>FRESH WATER TANK</b>	<b>6 gallon</b>
<b>WASTE WATER TANK</b>	<b>6 gallon</b>
<b>WATER PRESSURE</b>	<b>60 PSI</b>
<b>WARRANTY</b>	<b>One Year</b>
<b>Watts</b>	<b>1400</b>
<b>Amps</b>	<b>13.07</b>
<b>Volt</b>	<b>110</b>

Electrical: 110v, 13 Amps

- Options:
- Electric Foot Switch for hand free operation
  - Water Filtration
  - Flex Tube (for refilling water tank)
  - Locking Cabinet

Shipping Dimensions: 30 in. x 26 in. x 56 in.  
Shipping Weight: 130 lbs.

### Basin Measurements

Width	10"
Length	11"
Depth:	5.5"

### Model PSE-2001

TOP VIEW

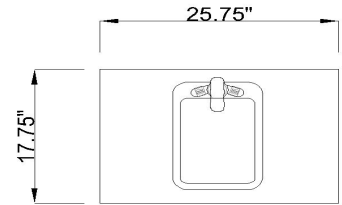

FRONT VIEW

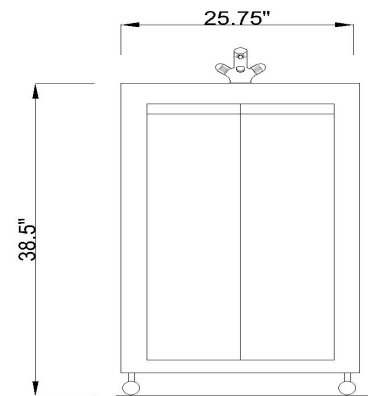

SIDE VIEW

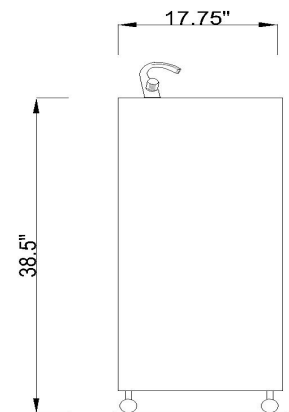

*Note: Dimensions and specs subject to change without notice.*